

Grandview[®]

Motorized Cable Manager Manual

Model:GSPC 12

Grandview[®]

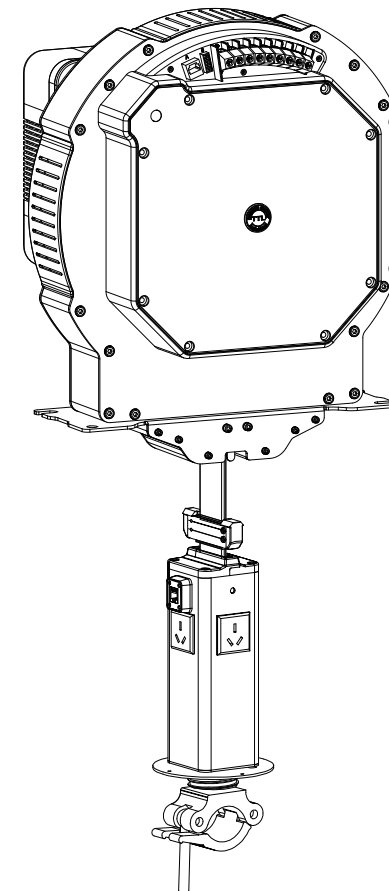

Guangzhou Grandview Creative Technology Co., Ltd
Add: No.1 Building of No.43 South International Trade Avenue,
Hualong Town, Panyu District, Guangzhou China.
Tel: +8620-8489-9499 Fax: +8620-8480-5299
[Http://www.grandviewscreen.com](http://www.grandviewscreen.com)



Thank you for purchasing this product. Please read instructions carefully before using. After installation, store instructions for future reference.

Grandview[®]

Important safety instructions

Attention: To reduce the risk of fire or electric shock , do not expose the product to rain or moisture.

- Please read through this manual before installation and use, and follow the instructions to avoid any damages .
 - Keep away from heat sources such as radiators, heaters, stoves and other equipment (including loudspeakers).
 - Can connect the power plug with a grounding wire only.
 - Require to use the accessories which are supplied by the same supplier only.
 - Please unplug the power cord in case of lightning storm or when the product is not used for a long time.
 - Please contact us for after-sales service of installation and repair.
 - Do not install the product in a location where is wet or likely to splash by water.
 - Please use an approved power cord (3-core power cord) / device interface / plug, the grounding plug should comply with the applicable national safety regulations.
 - Please use a power cord (3-wire cable)/device/interface/plug that meets the specified rating (voltage, current).
- If you have questions about the use of the above power cord/device interface/plug, please contact a qualified service technician.
- The installation position should have sufficient mechanical strength, and the load-bearing requirements should be able to bear 4 times of the product's weight. Otherwise, an accident may occurs or the lifting rigging point may fall off.

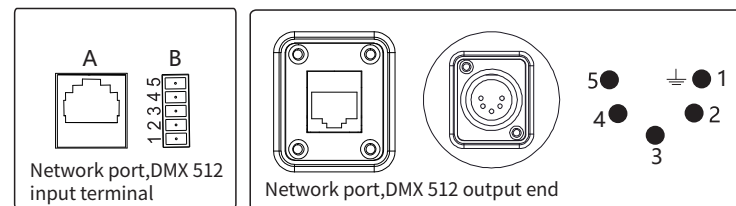
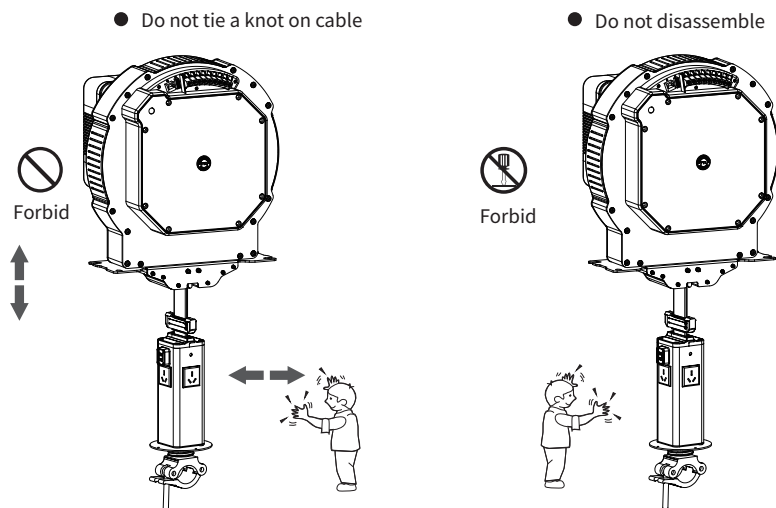

sheet 2

	Aerospace plug	External terminal
Wiring port	1 Ground wire	1 Ground wire
Wiring port	2	2
Wiring port	3	3
Wiring port	4	4
Wiring port	5	5

You can connect their ports autonomously according to your needs by using DMX 512 5-core communication cable.

[Warning]: When connecting the power cord and installing the power supply, be sure to operate it by a qualified electrician to avoid accidental product damage and personnel damage!

Group Code & Bit Code

After setting the group code and bit code, please refer to the control code shown below in the code list. The baud rate is 9600, and the hexadecimal code is issued. 0000 000 is the group control code, so the hanging point should be set to a group code other than 0000 000 with bit code.

example

control code

Bit code	group code	0000	0001	0010
000	up	F6 00 00 07 FD	F6 01 00 07 FE	
	stop	F6 00 00 09 FF	F6 01 00 09 00	
	down	F6 00 00 08 FE	F6 01 00 08 FF	
001	up	F6 00 01 07 FE	F6 01 01 07 FF	
	stop	F6 00 01 09 00	F6 01 01 09 01	
	down	F6 00 01 08 FF	F6 01 01 08 00	
010	up	F6 00 02 07 FF	F6 01 02 07 00	
	stop	F6 00 02 09 01	F6 01 02 09 02	
	down	F6 00 02 08 00	F6 01 02 08 01	
011	up	F6 00 03 07 00	F6 01 03 07 01	
	stop	F6 00 03 09 02	F6 01 03 09 03	
	down	F6 00 03 08 01	F6 01 03 08 02	

Power cable and signal line connecting diagram

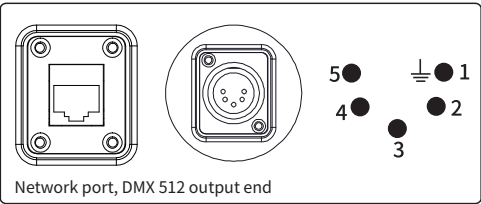
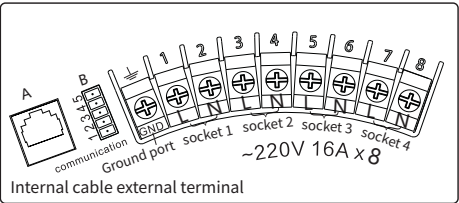

sheet 1

	External terminal	socket
Ground wire	Ground wire	Ground wire
Wiring port	L	socket 1
Wiring port	N	
Wiring port	L	socket 2
Wiring port	N	
Wiring port	L	socket 3
Wiring port	N	
Wiring port	L	socket 4
Wiring port	N	

Please refer to sheet-1 when you accesses the power cord. The wiring port required to be connected corresponding, so as to avoid the short circuit of the wire and damage of the product.

Product Structure

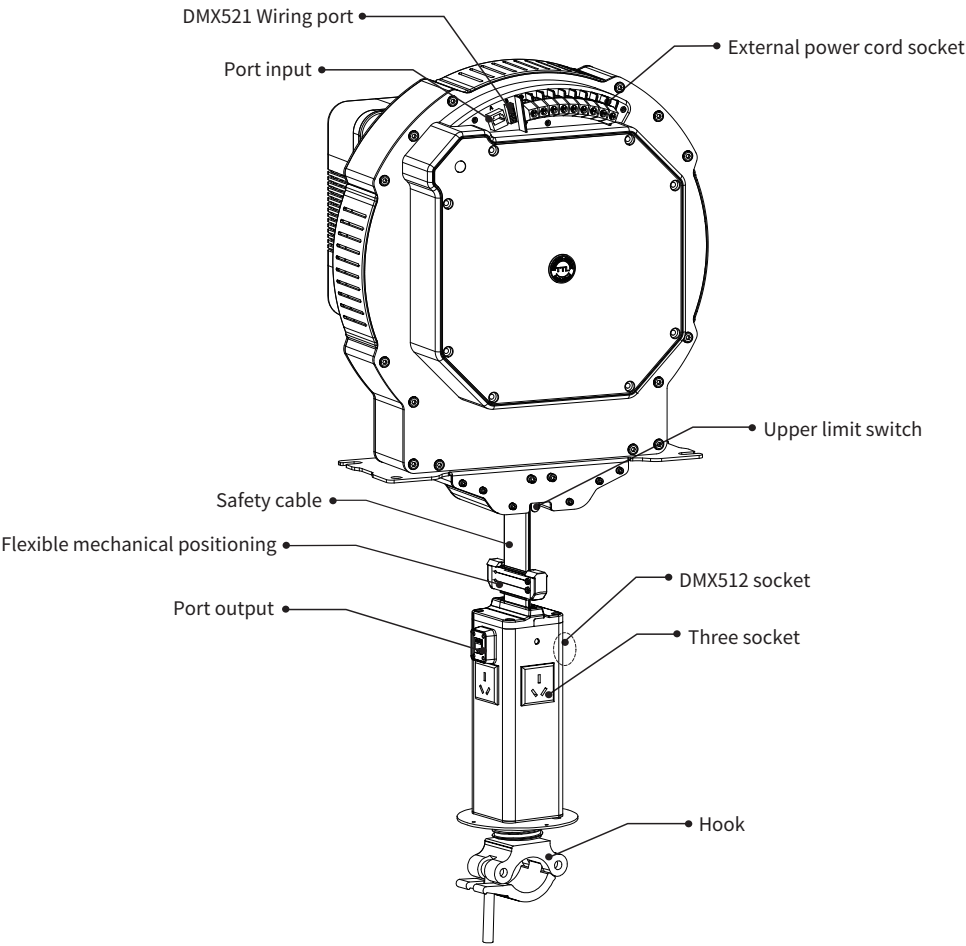

Standard Accessory

- 5-core DMX512 plug x 1
- Decoration plate x 1
- 6 Inches Cushion x 1
- M4x8 screw x 4
- Power cable x 1
- Manual x 1

Optional accessory

- wall switch

GSPC 12 size:

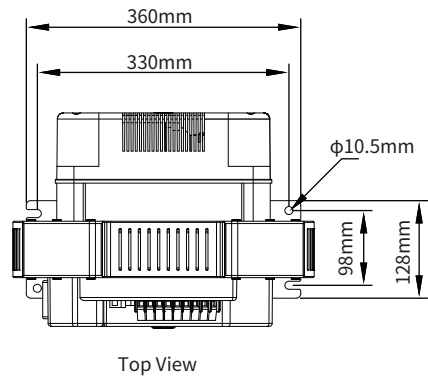
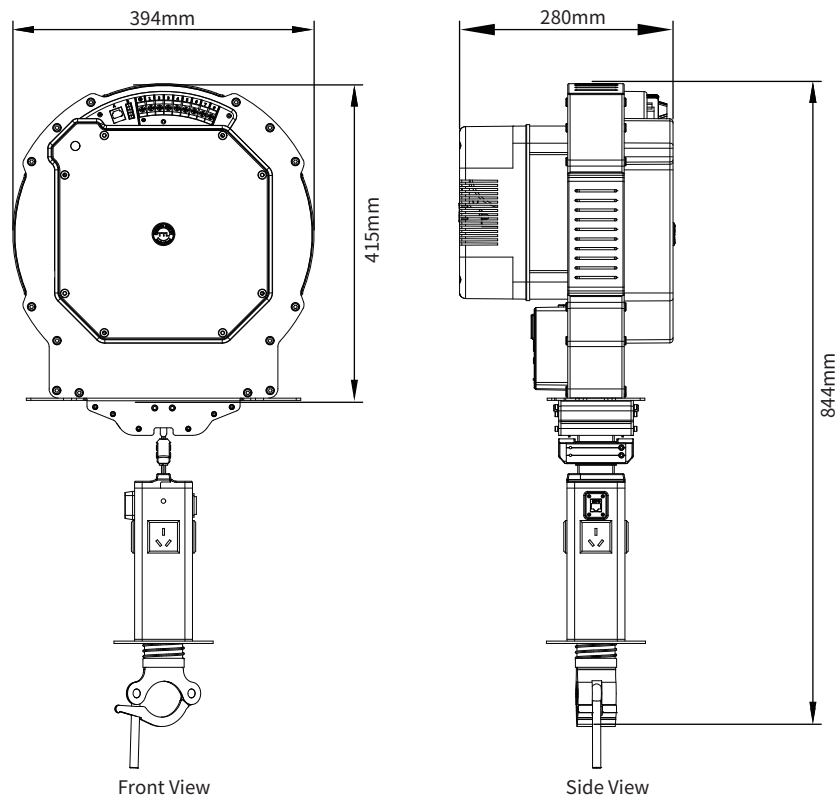

GSPC 12 Specification :
Product:Motorized cable manager
Model:GSPC 12
Size:W280xD394xH844mm
Installation Bold Hole Size:330x98mm
Ceiling open size:φ175mm
Max dropping distance: 12 Meter
Input Voltage: AC 220V/50Hz
Power rating:60W
Minimum speed: 4m/min
Control method: RS485、dry-contact
Cable manager interface: Aerospace plug,
AC250V/16A socket (4pcs), DMX512 5-core interface,
network interface

Group code and bit code setting

When using RS485, the group code and bit code must be set to non-zero, that is, at least one bit must be set to “ON”. When several devices are used to hang the same device (truss or secondary lifting screen, etc.) The controller group code of the device must be the same, but the bit code must be different. The bit code is used to distinguish which control device is used. The bit code is allocated by the customer or set by the engineer. When a place (such as the same When there are several sets of equipment in the banquet hall and the same conference room, the group code must be set differently.

RS485 protocol

Serial port setting - baud rate 9600, 8 data bits, 1 stop bit, Cyclic redundancy check (CRC).

1. Protocol format (hexadecimal):

Header (F6), group code, bit code, instruction code,

Check (single byte)

Check = header + group code + bit code + control command

Cyclic redundancy check (CRC) coding = generator polynomial - 1

Hanging client device Normal control	07	Ascending, the adaptive rigging point device performs the ascending operation (the cable is closed when the cable is loose, and the wire is stopped when it is tightened)
	08	Decline, the adaptive rigging point device does the down operation (Release the cable when it is tight and stop when it is loose.)
	09	Stop, the device will stop running when it is received

RS485 bit code dialing value

Bit code			Code value
The first one	Second	Third	Hexadecimal
OFF	OFF	OFF	00
OFF	OFF	ON	01
OFF	ON	OFF	02
OFF	ON	ON	03
ON	OFF	OFF	04
ON	OFF	ON	05
ON	ON	OFF	06
ON	ON	ON	07

RS485 group code dialing code value

Bit code				Code value
The first one	Second	Third	Fourth	Hexadecimal
OFF	OFF	OFF	OFF	00
OFF	OFF	OFF	ON	01
OFF	OFF	ON	OFF	02
OFF	OFF	ON	ON	03
OFF	ON	OFF	OFF	04
OFF	ON	OFF	ON	05
OFF	ON	ON	OFF	06
OFF	ON	ON	ON	07
ON	OFF	OFF	OFF	08
ON	OFF	OFF	ON	09
ON	OFF	ON	OFF	0a
ON	OFF	ON	ON	0b
ON	ON	OFF	OFF	0c
ON	ON	OFF	ON	0d
ON	ON	ON	OFF	0e
ON	ON	ON	ON	0f

Control Interface

Control panel button description

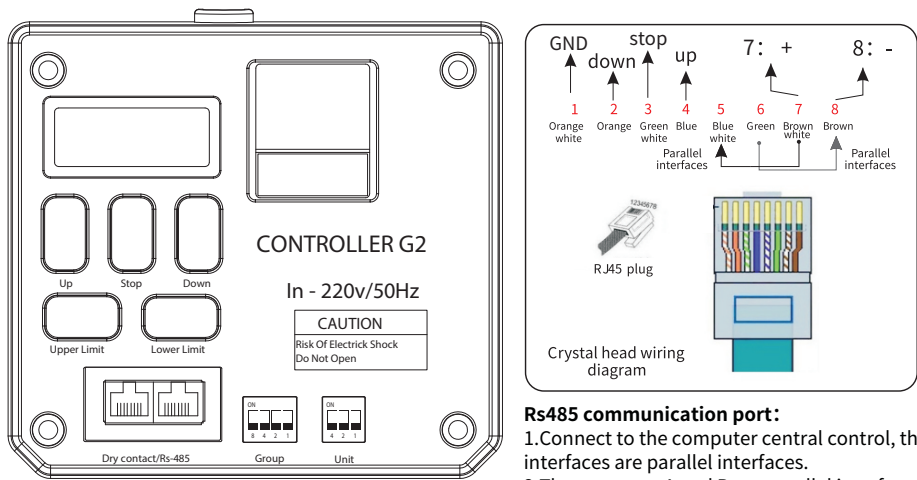

Group code:
When using RS485 control, the same group code is used for the lift of the same group control group

Bit code:
different lifts in the same group code are controlled by bit code

Panel button function and limit setting/ clear method

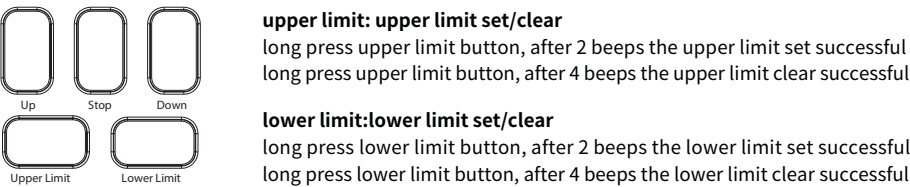

Mechanical positioning:

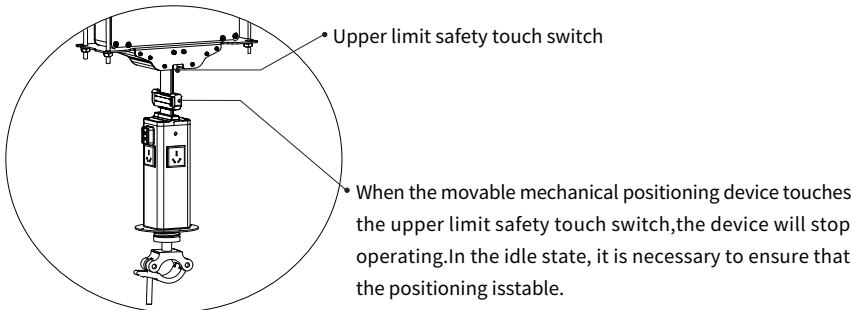

Installation Instruction

This product should be installed in the best projection position, it would be more convenient and more safe when the product being installed correctly, firstly, open the package and check if there is any missing parts, then take out all the parts and start the installation as per the instructions below, to make sure the product operates more safe and more convenient, pls read through the whole instruction carefully and choose the appropriate installation way based on the actual installation environment.

For the safer and more convenient use of the product, please read the installation part of this manual completely, and choose the most suitable installation method according to your actual situation!

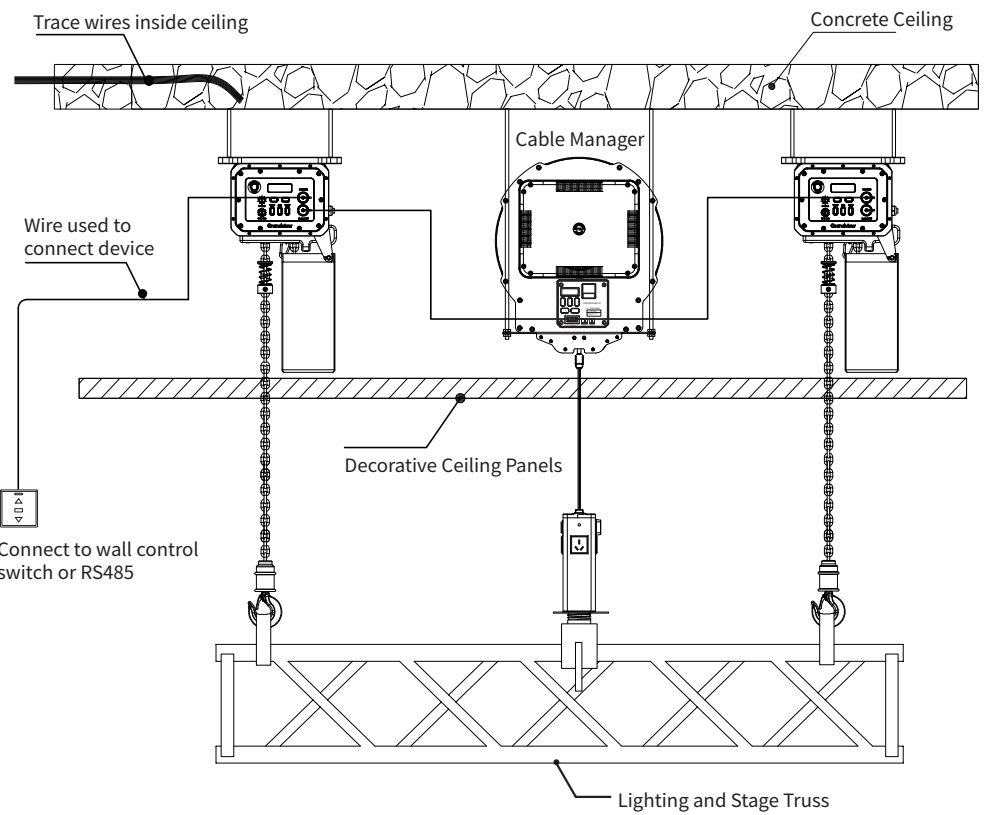

(Ceiling recessed electric lifting series installation diagram, GSPC 12 non-load bearing products)

Remark

- 1.If you choose wall control switch control , please connect to the dry contact port.
- 2.If you choose the computer central control, please connect to the RS485 port.
- 3.The hook must be vertical.

Installation steps

1. Determine the installation location of the product, install the expansion screw in the ceiling of the cement ceiling.

Screw rod size :330mmx 98mm

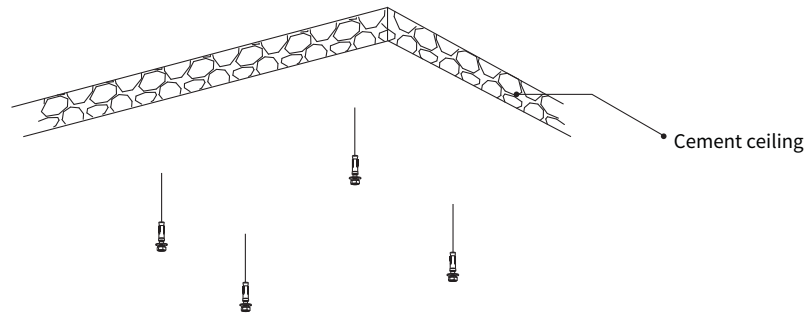

2. Install the screw rod in the right position.

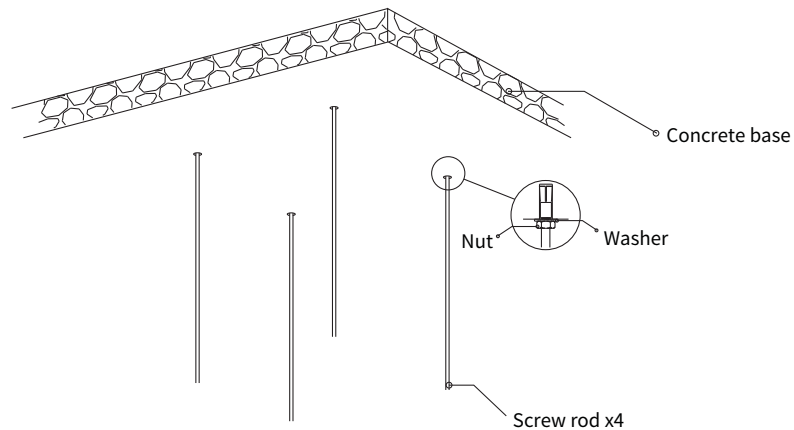

3. Grille ceiling opening

Ceiling install hole size: $\phi 175\text{mm}$

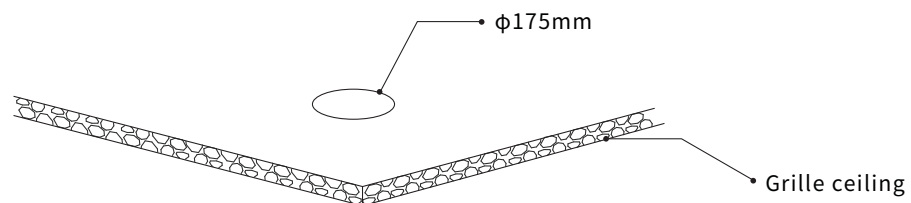

Installation steps

4. Pass the screw through the screw rod's hole of the product and tighten the screw rod with a nut.

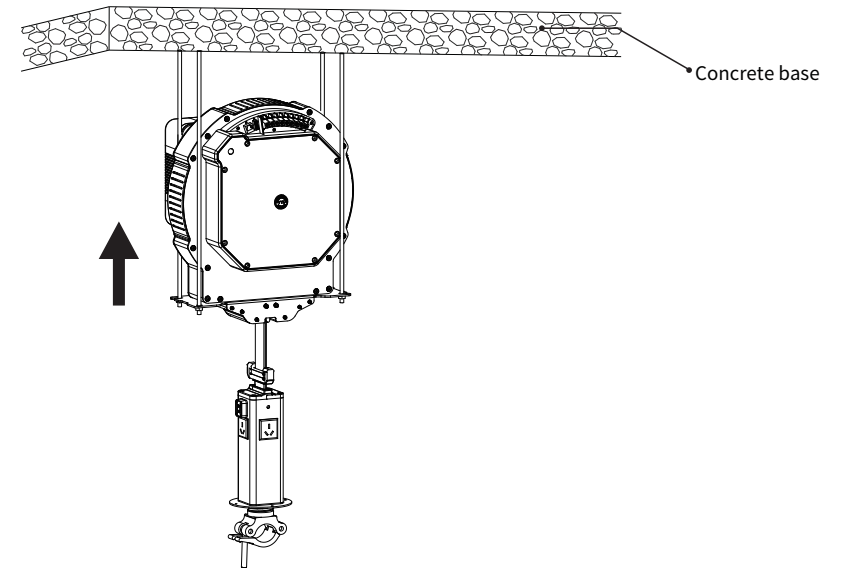

5. Adjust the cable manager to keep the device in a horizontal state, the cable is in the middle of the ceiling opening, and the cable cannot be scraped to the device outlet.

6. Install the ceiling decorative plate and screw the matching screws.

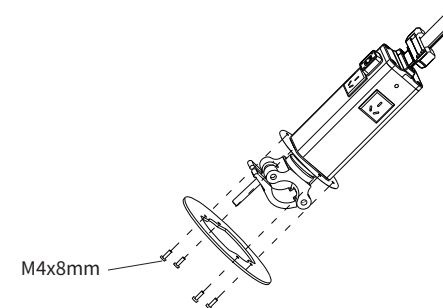

7. Initial power-on, determine whether the upper limit and the upper stop down are normal, then perform electrical debugging.